

LEGEND: () = QUANTITY/TOOL
 * = QUANTITY/MULTI-PAK

10616 (1)
 RADIO KIT 2.4GHZ; AAA FOR LARGE SLTC-FM
 WRENCHES (INCLUDES AAA BATTERY HOUSING
 UPPER & LOWER COVERS, BATTERY HOUSING
 LID, RADIO 2.4GHZ AAA, RUBBER WASHERS,
 SCREW PAN HEAD, LITEPIPE & SPRING CLIP,
 PCB INSULATION, SLTC LABEL, & AAA BATTERY)

NOTES:

- TIGHTEN TO 1.5-2.5 IN. LBS. AND
 APPLY A DROP OF ADHESIVE
 (PERMA-LOK MM115 OR LOCTITE
 262) TO SET SCREW (890104)
 PRIOR TO ASSEMBLY INTO TANG
 (814109).

WARNING: USE ONLY 1.5 VDC
 ALKALINE OR 1.2 VDC NIMH AAA
 RECHARGEABLE BATTERIES.
 OTHER BATTERIES CAN CAUSE
 DAMAGE TO RADIO AND IMPACT
 THE RADIO SIGNAL.

816799 - THIS PIN IS FORMED OVER
CUSTOMER MUST GRIND OFF FORMED END
 & INSTALL THIS PIN FORMING THE HEAD
 OVER THE RETAINING RING AS SHOWN.

DETAIL A
 SCALE 1 : 1.5
 DEFORM BEFORE
 CALIBRATION

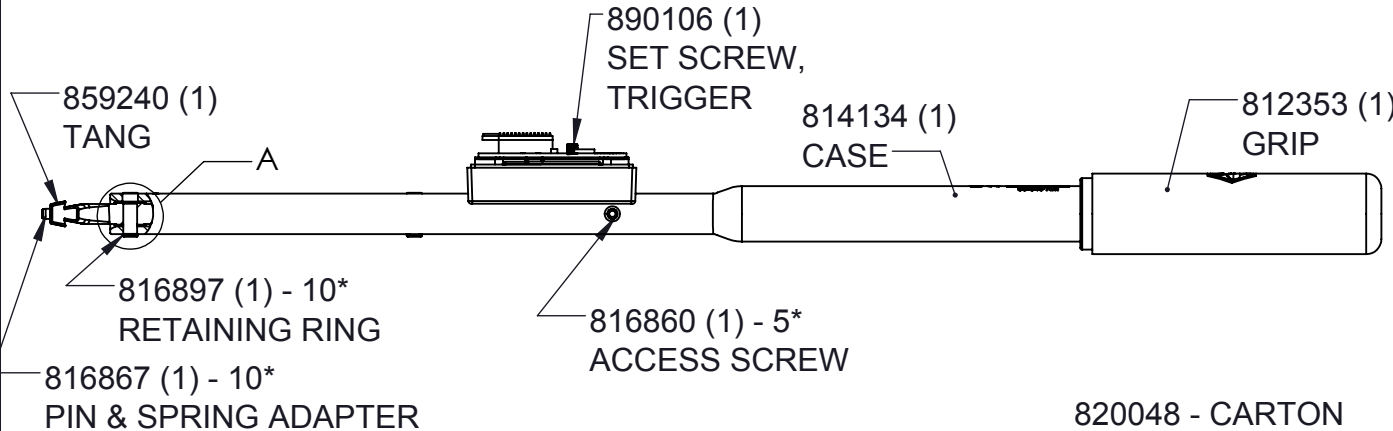
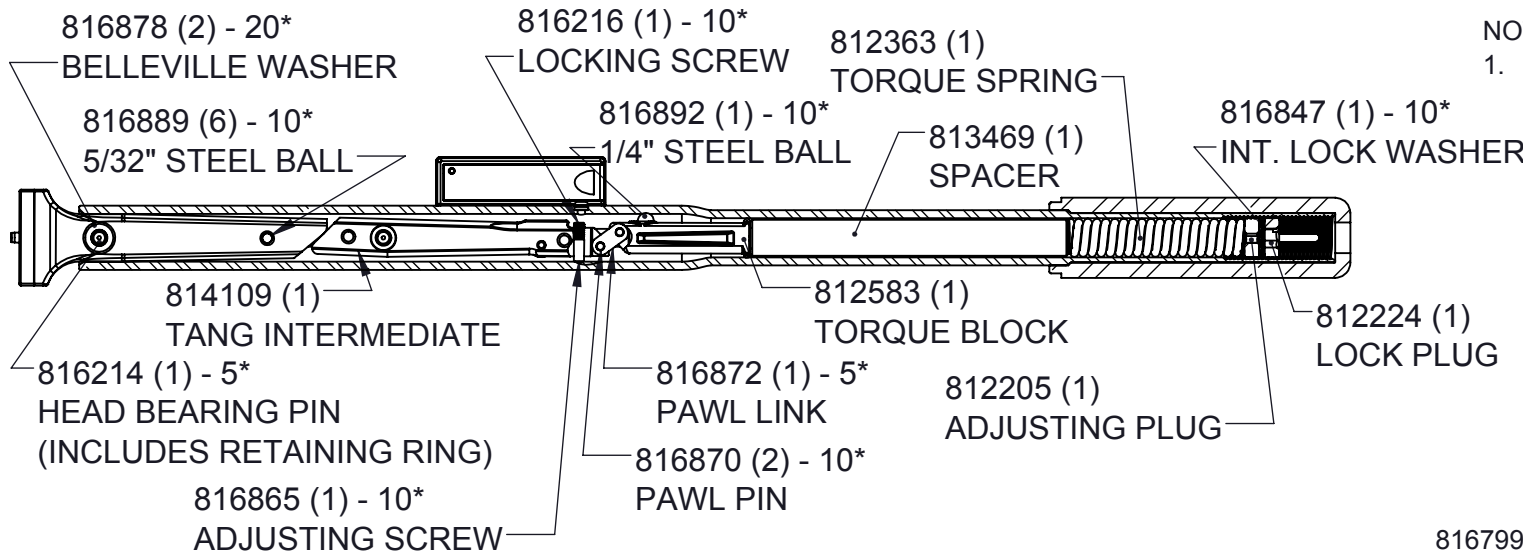
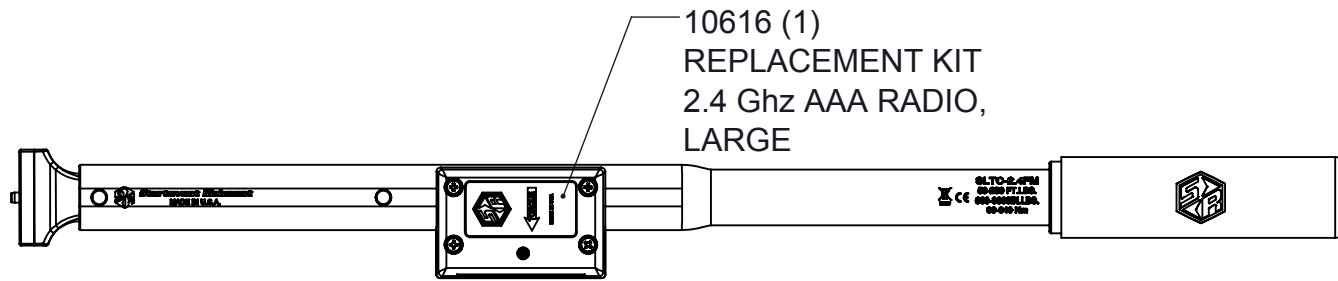
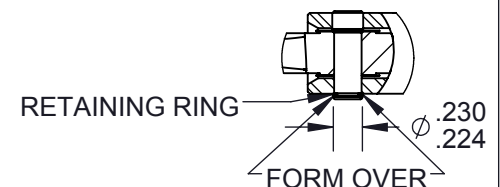

820048 - CARTON
 857331 - INSTRUCTIONS