

Interchangeable Heads – Ratcheting Open End (36.5 mm)

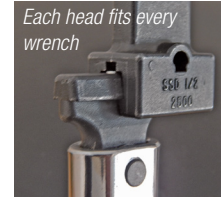
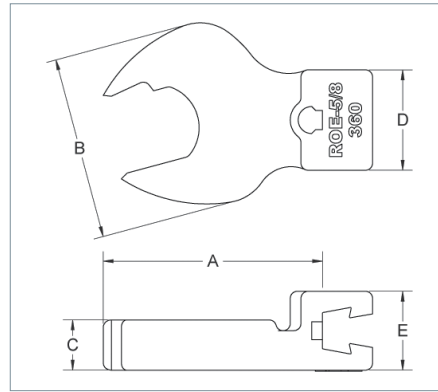

Interchangeable open end head with 15 degrees opening offset. Sturtevant Richmond's **Ratcheting Open End (ROE)** are ideal, when:

- ➔ Entire hex of fastener or fitting cannot be engaged,
- ➔ Significant rotation of the fastener or fitting is required (more than 120 degrees),
- ➔ The hex of the fastener can be engaged and must be rotated quickly with minimum clearance,
- ➔ A moderate level of head strength (torque level) is needed.

Cast as a single piece from alloy steel. The manufacturing method provides strength and durability rarely attained by the more common "cut & weld" method.

To achieve constant torque values when changing heads, exact lever length must be maintained. Virtually all SR heads share a precise distance from end of wrench to center of fastener. This is referred to as a "Common Center Line".

The unique Sturtevant Richmond dovetail design used to join head and wrench provides an exceptionally strong connection and allows complete interchangeability. The SR system contributes to both operational flexibility and enhancing your return on investment!

- ▶ 15 degrees opening offset.
- ▶ SR dovetail connector with outstanding rigidity and wear resistance.
- ▶ Cast Alloy Steel, black finished.
- ▶ Common centre line 1 7/16 inch (~36.5 mm).
- ▶ Suitable with dovetail torque wrench series
 - ✓ LTC / SLTC / SLTC-FM
 - ✓ DTC
 - ✓ CCM up to capacity 200 Nm resp. 1800 in.lb / 150 ft.lb
 - ✓ Exacta
 - ✓ TAC

INFO

The term '**Common Center Line**' means the distance from the base of the dovetail connector to the center of the rotary axis in the interchangeable head.

Sturtevant Richmond achieves an exactly constant center distance through the special manufacturing process – from one casting.

ROE – metric

Model	Item No.	A/F mm	max N-m	Dimensions mm				
				A	B	C	D	E
ROE-9MM	R819219	9	13	43.2	27.0	6.4	19.1	17.5
ROE-10MM	R819220	10	13	43.2	27.0	6.4	19.1	17.5
ROE-11MM	R819221	11	20	43.2	27.0	6.4	19.1	17.5
ROE-12MM	R819222	12	23	45.7	33.3	7.9	19.1	17.5
ROE-13MM	R819223	13	23	45.7	33.3	7.9	19.1	17.5
ROE-14MM	R819224	14	27	45.7	33.3	7.9	19.1	17.5
ROE-15MM	R819225	15	40	45.7	40.5	8.7	22.2	17.5
ROE-16MM	R819226	16	40	45.7	40.5	8.7	22.2	17.5
ROE-17MM	R819227	17	54	45.7	40.5	8.7	22.2	17.5
ROE-18MM	R819228	18	54	45.7	40.5	8.7	22.2	17.5
ROE-19MM	R819229	19	68	48.3	46.8	10.3	25.4	20.6
ROE-22MM	R819231	22	101	50.8	54.0	11.1	31.8	20.6
ROE-24MM	R819232	24	118	50.8	54.0	11.1	31.8	20.6
ROE-27MM	R819233	27	152	53.3	58.7	11.9	31.8	20.6
ROE-28MM	R819234	28	170	53.3	58.7	11.9	31.8	20.6
ROE-29MM	R819235	29	152	58.4	71.1	12.7	31.8	20.6

ROE – inch

Model	Item No.	A/F inch	max. lbf-in	Dimensions mm				
				A	B	C	D	E
ROE-5/16	R819201	5/16	90	41.7	19.1	6.4	19.1	17.5
ROE-3/8	R819202	3/8	120	41.3	27.0	6.4	19.1	17.5
ROE-7/16	R819203	7/16	180	43.7	27.0	6.4	19.1	17.5
ROE-1/2	R819204	1/2	210	43.7	33.3	7.9	19.1	17.5
ROE-9/16	R819205	9/16	240	46.8	33.3	7.9	19.1	17.5
ROE-5/8	R819206	5/8	360	46.8	40.5	8.7	22.2	17.5
ROE-11/16	R819207	11/16	480	47.6	40.5	8.7	22.2	17.5
ROE-3/4	R819208	3/4	600	50.8	46.8	10.3	25.4	20.6
ROE-13/16	R819209	13/16	750	50.0	46.8	10.3	25.4	20.6
ROE-7/8	R819210	7/8	900	50.0	54.0	11.1	31.8	20.6
ROE-15/16	R819211	15/16	1050	49.6	54.0	10.3	31.8	31.8
ROE-1	R819212	1	1200	55.9	58.3	12.7	31.8	31.8
ROE-1.1/8	R819214	1 1/8	1500	58.3	71.1	12.7	31.8	31.8
ROE-1.3/16	R819215	1 3/16	1650	58.3	71.1	12.7	31.8	31.8

