

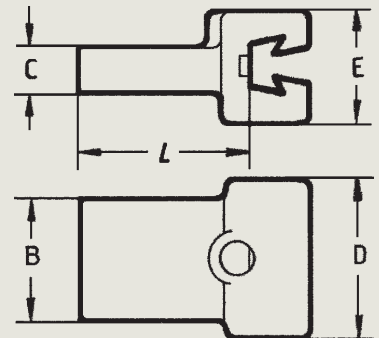

Interchangeable Heads Dovetail – Adaptors



The STA tooling adaptor is ideal, when you need to make a custom head and wish to use it with an S/R interchangeable head torque wrench.

When creating custom heads to use with micrometer adjustable torque wrenches (CCM-Series tools) it is critical that the common centerline length be correct or the tool will not apply the indicated torque. When fabricating special heads to use with CCM-Series torque wrenches other than the CCM 300 and the CCM 400, the 1 7/16" common centerline length must be maintained. When fabricating special heads to use with the CCM 300 and CCM 400, a 3 7/8" common centerline length must be maintained.

- Standard Tooling Adaptor for manufacturing of custom heads.
- S/R dovetail connector with outstanding rigidity and wear resistance.
- Made from heat treated 4140 alloy steel, black finished.
- On request we can supply special tool heads according to drawing and/or samples.



Recommended for use with S/R preset torque wrenches series LTC.

STA

Model	Part No.	max. N-m	Dimensions mm					Price €	PG
			L	B	C	D	E		
STA-1	R819901	181	23.8	14.3	6.4	19	18	15	
STA-2	R819902	282	30.1	22.2	8.7	29	21	15	
STA-3	R809917	542	38.1	38.1	12.7	38	25	15	

Other Adaptors



The S/R Crowfoot Adapter is intended for use with S/R Flat and Tapered Beam torque wrenches. The actual torque output will be different from that shown on the scale of the wrench and must be calculated.

- Always mount parallel to beam.
- Centerline = 39 mm.
- R850653 SRA-3/8".
- R850655 SRA-1/2".



These adaptors allow those who have interchangeable heads of the round style (round male connector) to use them with S/R preset interchangeable head torque wrenches.

- Use with series LTC only.
- Always pre-set torque wrench with attached head and adaptor.
- R853021 BAJ for Type „J“.
- R853022 BAY for Type „Y“.



These adaptors allow those who have interchangeable heads of the DIN style (male rectangular connector) to use them with S/R preset interchangeable head torque wrenches.

- Use with series LTC only.
- Always pre-set torque wrench with attached head and adaptor.
- R819136 Adaptor 9x12 mm.
- R819137 Adaptor 14x18 mm.

Prices are valid per unit in Euro plus VAT and/or any custom fees exw Hamburg, incl. packing. Subject to change. Errors excepted.

ZEMO Vertriebs GmbH · Peutestr. 47 · 20539 Hamburg · Tel: +49 (0)40-789181-02 · Fax: +49 (0)40-789181-12 · E-Mail: info@zemo-tools.de

