

1/2 Power Sockets with 1/2" square drive according to DIN 3121 G 12.5



4-point – normal

Model	Item No.	A/F mm	L mm	D1 mm	D2 mm	L2 mm	Pk
K1/2-7-VK	230487	7	40	17.5	25	8.0	5
K1/2-8-VK	230470	8	40	19.0	25	9.0	5
K1/2-10-VK	230471	10	40	21.5	25	10.0	5
K1/2-11-VK	230472	11	40	23.0	25	11.0	5
K1/2-12-VK	230473	12	40	24.0	25	12.0	5
K1/2-13-VK	230474	13	40	26.0	30	12.0	5
K1/2-14-VK	230475	14	40	27.5	30	20.0	5
K1/2-15-VK	230476	15	40	28.5	30	20.0	5
K1/2-16-VK	230477	16	40	30.0	30	20.0	5
K1/2-17-VK	230478	17	40	32.0	30	20.0	5
K1/2-18-VK	230479	18	45	34.0	30	20.0	5
K1/2-19-VK	230480	19	45	36.0	30	20.0	5
K1/2-21-VK	230481	21	45	40.0	30	20.0	5
K1/2-22-VK	230482	22	45	42.0	30	20.0	5
K1/2-24-VK	230483	24	50	44.0	30	22.0	5
K1/2-30-VK	230485	30	50	53.0	30	22.0	5
K1/2-32-VK	230486	32	50	56.0	30	22.0	5



6-point – normal – inch

Model	Item No.	A/F inch	L mm	D1 mm	D2 mm	L2 mm	Pk
K1/2-3/8	230050	3/8	38	16.0	22	12.0	5
K1/2-7/16	230051	7/16	38	18.0	22	12.0	5
K1/2-1/2	230052	1/2	38	20.0	22	12.0	5
K1/2-9/16	230053	9/16	38	22.0	24	12.0	5
K1/2-5/8	230054	5/8	38	25.0	25	12.0	5
K1/2-11/16	230055	11/16	38	26.0	26	13.0	5
K1/2-3/4	230056	3/4	38	28.0	28	13.0	5
K1/2-13/16	230057	13/16	38	30.0	30	13.0	5
K1/2-7/8	230058	7/8	38	32.0	32	13.0	5
K1/2-15/16	230059	15/16	38	34.0	34	13.0	5
K1/2-1	230060	1	38	36.0	36	14.0	5
K1/2-1.1/16	230061	1 1/16	40	38.0	38	16.0	5
K1/2-1.1/8	230062	1 1/8	40	40.0	38	16.0	5
K1/2-1.3/16	230063	1 3/16	40	42.0	38	16.0	5
K1/2-1.1/4	230064	1 1/4	40	44.0	38	18.0	5
K1/2-1.3/8	230065	1 3/8	50	48.5	38	26.0	
K1/2-1.7/16	230066	1 7/16	50	50.5	38	26.0	
K1/2-1.1/2	230067	1 1/2	50	52.5	38	26.0	



6-point – normal

Model	Item No.	A/F mm	L mm	D1 mm	D2 mm	L2 mm	Pk
K1/2-8	230010	8	38	14.5	25	9.0	5
K1/2-9	230011	9	38	16.0	25	12.0	5
K1/2-10	230012	10	38	17.0	25	12.0	5
K1/2-11	230013	11	38	19.0	25	12.0	5
K1/2-12	230014	12	38	20.0	24	12.0	5
K1/2-13	230015	13	38	21.0	25	12.0	5
K1/2-14	230016	14	38	22.0	25	12.0	5
K1/2-15	230017	15	38	24.0	30	12.0	5
K1/2-16	230018	16	38	25.0	30	12.0	5
K1/2-17	230019	17	38	26.0	30	13.0	5
K1/2-18	230021	18	38	27.5	30	13.0	5
K1/2-19	230022	19	38	29.0	30	13.0	5
K1/2-20	230024	20	38	30.0	30	13.0	5
K1/2-21	230025	21	38	32.0	30	13.0	5
K1/2-22	230026	22	38	32.0	30	13.0	5
K1/2-23	230027	23	38	32.5	30	13.0	5
K1/2-24	230028	24	45	35.0	30	20.0	5
K1/2-25	230029	25	45	36.0	30	20.0	5
K1/2-26	230030	26	45	37.5	30	22.0	5
K1/2-27	230031	27	50	39.0	30	22.0	5
K1/2-28	230032	28	50	40.0	30	22.0	5
K1/2-29	230033	29	50	41.0	30	22.0	5
K1/2-30	230034	30	50	42.5	30	22.0	5
K1/2-32	230035	32	50	44.0	30	28.0	5
K1/2-34	230036	34	50	45.0	30	28.0	5
K1/2-36	230037	36	50	48.0	30	28.0	5
K1/2-38	230038	38	50	53.0	38	24.0	
K1/2-41	230039	41	60	58.0	44	27.0	
K1/2-46	230040	46	70	65.0	44	30.0	
K1/2-50	230041	50	70	70.0	52	32.0	

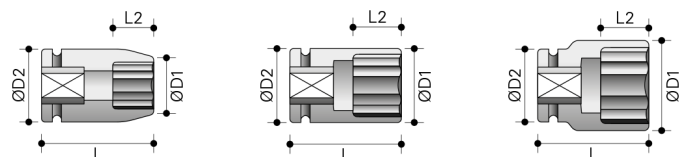

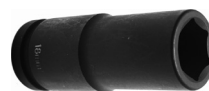
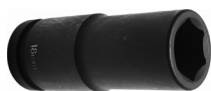

6-point – deep

Model	Item No.	A/F	L mm	D1 mm	D2 mm	L2 mm	Pk
K1/2-8-L	230210	8	78	14.5	25	13.0	5
K1/2-9-L	230211	9	78	16.0	25	14.0	5
K1/2-10-L	230212	10	78	17.0	25	14.0	5
K1/2-11-L	230213	11	78	18.0	25	14.0	5
K1/2-12-L	230214	12	78	19.5	25	14.0	5
K1/2-13-L	230215	13	78	21.0	25	14.0	5
K1/2-14-L	230216	14	78	22.0	25	17.0	5
K1/2-15-L	230217	15	78	23.5	30	17.0	5
K1/2-16-L	230218	16	78	23.5	30	17.0	5
K1/2-17-L	230219	17	78	26.0	30	17.0	5
K1/2-18-L	230220	18	78	26.0	30	17.0	5
K1/2-19-L	230221	19	78	28.0	30	19.0	5
K1/2-20-L	230222	20	78	30.5	30	19.0	5
K1/2-21-L	230223	21	78	31.0	30	24.0	5
K1/2-22-L	230224	22	78	32.5	30	24.0	5
K1/2-23-L	230225	23	78	32.5	30	24.0	5
K1/2-24-L	230226	24	78	35.0	30	24.0	5
K1/2-25-L	230227	25	78	36.0	30	24.0	5
K1/2-26-L	230228	26	78	37.5	30	24.0	5
K1/2-27-L	230229	27	78	38.0	30	24.0	5
K1/2-28-L	230230	28	78	40.0	30	24.0	5
K1/2-29-L	230231	29	78	40.0	30	24.0	5
K1/2-30-L	230232	30	78	42.0	30	24.0	5
K1/2-31-L	230233	31	78	43.0	30	24.0	5
K1/2-32-L	230234	32	78	45.0	30	24.0	5
K1/2-33-L	230235	33	78	45.0	30	24.0	5
K1/2-34-L	230236	34	78	45.0	30	24.0	5
K1/2-35-L	230237	35	78	47.0	30	24.0	5
K1/2-36-L	230238	36	78	49.0	30	24.0	5
K1/2-38-L	230239	38	93	53.0	38	24.0	
K1/2-41-L	230240	41	93	48.0	44	58.0	
K1/2-46-L	230241	46	93	65.0	44	58.0	

6-point – deep – inch

Model	Item No.	A/F inch	L mm	D1 mm	D2 mm	L2 mm	Pk
K1/2-3/8-L	230258	3/8	78	16.0	22	14.0	5
K1/2-7/16-L	230250	7/16	78	18.0	22	14.0	5
K1/2-1/2-L	230251	1/2	78	20.0	22	14.0	5
K1/2-9/16-L	230252	9/16	78	22.0	24	17.0	5
K1/2-5/8-L	230253	5/8	78	26.0	26	17.0	5
K1/2-11/16-L	230254	11/16	78	26.0	26	17.0	5
K1/2-3/4-L	230255	3/4	78	28.0	28	19.0	5
K1/2-13/16-L	230256	13/16	78	30.0	30	24.0	5
K1/2-7/8-L	230257	7/8	78	32.0	32	24.0	5
K1/2-15/16-L	230259	15/16	78	28.0	28	24.0	
K1/2-1-L	230260	1"	78	36.0	36	24.0	
K1/2-1-1/16-L	230261	1 1/16	78	38.0	38	24.0	
K1/2-1-1/8-L	230262	1 1/8	78	40.0	38	24.0	
K1/2-1-3/16-L	230263	1 3/16	78	42.0	38	24.0	
K1/2-1-1/4-L	230264	1 1/4	78	44.0	38	24.0	
K1/2-1-5/16-L	230265	1 5/16	78	45.0	38	24.0	
K1/2-1-3/8-L	230266	1 3/8	78	48.5	38	24.0	
K1/2-1-7/16-L	230267	1 7/16	78	50.5	38	24.0	
K1/2-1-1/2-L	230268	1 1/2	78	52.5	38	24.0	

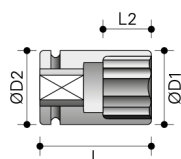

For more
info, visit our
website.

24/7

1/2 Power Sockets with 1/2" square drive according to DIN 3121 G 12.5



6-point – XL & XXL

Model	Item No.	A/F mm	L mm	D1 mm	D2 mm	L2 mm	Pk
K1/2-8-150	230350	8	150	15.0	25	10.0	-
K1/2-10-150	230351	10	150	17.0	25	12.0	-
K1/2-12-150	230352	12	150	19.5	25	12.0	-
K1/2-13-150	230353	13	150	20.5	25	12.0	-
K1/2-14-150	230354	14	150	22.0	25	12.0	-
K1/2-15-150	230355	15	150	23.0	25	12.0	-
K1/2-17-150	230356	17	150	25.5	25	13.0	-
K1/2-19-150	230357	19	150	28.0	25	13.0	-
K1/2-20-150	230358	20	150	30.0	25	13.0	-
K1/2-21-150	230359	21	150	30.0	25	13.0	-
K1/2-22-150	230360	22	150	32.0	30	14.0	-
K1/2-24-150	230361	24	150	34.0	30	14.0	-
K1/2-25-150	230362	25	150	36.0	30	15.0	-
K1/2-8-200	230410	8	200	15.0	25	10.0	-
K1/2-10-200	230411	10	200	17.0	25	12.0	-
K1/2-12-200	230412	12	200	19.5	25	12.0	-
K1/2-13-200	230413	13	200	20.5	25	12.0	-
K1/2-14-200	230414	14	200	22.0	25	12.0	-
K1/2-15-200	230415	15	200	23.0	25	12.0	-
K1/2-17-200	230416	17	200	25.5	25	13.0	-
K1/2-19-200	230417	19	200	28.0	25	13.0	-
K1/2-20-200	230418	20	200	30.0	25	13.0	-
K1/2-21-200	230419	21	200	30.0	25	13.0	-
K1/2-8-250	230450	8	250	15.0	25	10.0	-
K1/2-10-250	230451	10	250	17.0	25	12.0	-
K1/2-12-250	230452	12	250	19.5	25	12.0	-
K1/2-13-250	230453	13	250	20.5	25	12.0	-
K1/2-14-250	230454	14	250	22.0	25	12.0	-
K1/2-15-250	230455	15	250	23.0	25	12.0	-
K1/2-17-250	230456	17	250	25.5	25	13.0	-
K1/2-19-250	230457	19	250	28.0	25	13.0	-
K1/2-20-250	230458	20	250	30.0	25	13.0	-
K1/2-21-250	230459	21	250	30.0	25	13.0	-
K1/2-22-250	230460	22	250	32.0	30	14.0	-

6-point – with joint*

Model	Item No.	A/F mm	L mm	D1 mm	D2 mm	L2 mm	Pk
KG1/2-10	230710	10	65	15.0	28	14.0	-
KG1/2-11	230711	11	65	17.0	28	14.0	-
KG1/2-12	230712	12	65	19.0	28	14.0	-
KG1/2-13	230713	13	65	20.0	28	14.0	-
KG1/2-14	230714	14	65	22.0	28	14.0	-
KG1/2-15	230715	15	65	23.0	28	14.0	-
KG1/2-16	230716	16	65	23.0	28	14.0	-
KG1/2-17	230717	17	65	26.0	32	14.0	-
KG1/2-18	230718	18	65	26.0	32	14.0	-
KG1/2-19	230719	19	65	28.0	32	14.0	-
KG1/2-20	230720	20	65	30.0	32	14.0	-
KG1/2-21	230721	21	65	30.0	32	14.0	-
KG1/2-22	230722	22	65	32.0	32	14.0	-
KG1/2-23	230723	23	65	32.0	32	14.0	-
KG1/2-24	230724	24	65	34.0	32	14.0	-
KG1/2-10-L	230750	10	90	15.0	28	14.0	-
KG1/2-11-L	230751	11	90	17.0	28	20.0	-
KG1/2-12-L	230752	12	90	19.0	28	20.0	-
KG1/2-13-L	230753	13	90	20.0	28	20.0	-
KG1/2-14-L	230754	14	90	22.0	28	20.0	-
KG1/2-15-L	230755	15	90	23.0	28	20.0	-
KG1/2-16-L	230756	16	90	23.0	28	20.0	-
KG1/2-17-L	230757	17	90	26.0	32	20.0	-
KG1/2-18-L	230758	18	90	26.0	32	20.0	-
KG1/2-19-L	230759	19	90	28.0	32	25.0	-
KG1/2-20-L	230760	20	90	30.0	32	25.0	-
KG1/2-21-L	230761	21	90	30.0	32	25.0	-
KG1/2-22-L	230762	22	90	32.0	32	25.0	-
KG1/2-23-L	230763	23	90	32.0	32	25.0	-
KG1/2-24-L	230764	24	90	34.0	32	25.0	-
KG1/2-15-EL	230812	15	150	22.0	25	9.0	-
KG1/2-16-EL	230813	16	150	23.0	25	9.5	-
KG1/2-17-EL	230814	17	150	25.0	25	9.5	-
KG1/2-18-EL	230815	18	150	26.0	25	11.0	-
KG1/2-19-EL	230816	19	150	28.0	25	11.5	-

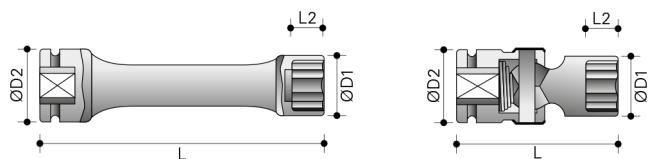

* excluded from the manufacturer's warranty.





6-point – thin-walled* – normal

Model	Item No.	A/F mm	L mm	D1 mm	D2 mm	L2 mm	Pk
K1/2-8-DW	230848	8	38	13.0	25	6.0	5
K1/2-9-DW	230849	9	38	14.5	25	6.0	5
K1/2-10-DW	230850	10	38	15.5	25	7.0	5
K1/2-11-DW	230851	11	38	16.7	25	8.0	5
K1/2-12-DW	230852	12	38	18.0	25	9.0	5
K1/2-13-DW	230853	13	38	19.2	25	9.0	5
K1/2-14-DW	230854	14	38	21.0	25	11.0	5
K1/2-15-DW	230855	15	38	21.7	30	11.0	5
K1/2-16-DW	230856	16	38	23.0	30	11.0	5
K1/2-17-DW	230857	17	38	24.0	30	11.0	5
K1/2-18-DW	230858	18	38	25.0	30	13.0	5
K1/2-19-DW	230859	19	38	26.0	30	13.0	5
K1/2-20-DW	230862	20	38	27.5	30	13.0	5
K1/2-21-DW	230860	21	38	28.0	30	15.0	5
K1/2-22-DW	230861	22	38	29.5	30	15.0	5
K1/2-23-DW	230863	23	38	30.5	30	15.0	5
K1/2-24-DW	230864	24	45	32.0	30	18.0	5
K1/2-30-DW	230865	30	50	40.0	30	21.0	5



6-point Fast Lead – normal

Model	Item No.	A/F mm	L mm	D1 mm	D2 mm	L2 mm	Pk
K1/2-10-FL	230610	10	38	17.0	25	8.0	5
K1/2-13-FL	230613	13	38	20.8	25	9.0	5
K1/2-15-FL	230615	15	38	23.5	30	11.0	5
K1/2-16-FL	230616	16	38	24.5	30	11.0	5
K1/2-17-FL	230617	17	38	25.7	30	12.0	5
K1/2-18-FL	230618	18	38	27.0	30	13.0	5
K1/2-19-FL	230619	19	38	28.2	30	13.0	5
K1/2-21-FL	230621	21	38	30.7	30	14.0	5
K1/2-22-FL	230622	22	38	32.0	30	15.0	5
K1/2-24-FL	230623	24	38	34.5	30	15.0	5
K1/2-27-FL	230624	27	40	38.2	30	16.0	5

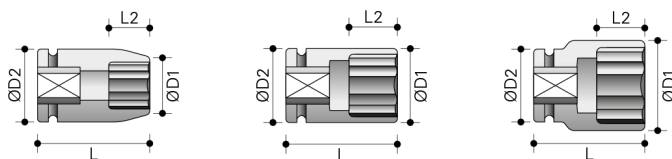

6-point – thin-walled* – deep

Model	Item No.	A/F mm	L mm	D1 mm	D2 mm	L2 mm	Pk
K1/2-8-DWL	230910	8	78	14.0	22	13.0	5
K1/2-9-DWL	230911	9	78	14.5	22	14.0	5
K1/2-10-DWL	230912	10	78	15.5	22	14.0	5
K1/2-11-DWL	230913	11	78	16.7	22	14.0	5
K1/2-12-DWL	230914	12	78	18.0	22	14.0	5
K1/2-13-DWL	230915	13	78	19.2	24	14.0	5
K1/2-14-DWL	230916	14	78	21.0	24	17.0	5
K1/2-15-DWL	230917	15	78	21.7	24	17.0	5
K1/2-16-DWL	230918	16	78	23.0	24	17.0	5
K1/2-17-DWL	230919	17	78	24.0	24	17.0	5
K1/2-18-DWL	230920	18	78	25.0	25	17.0	5
K1/2-19-DWL	230921	19	78	26.0	26	19.0	5
K1/2-20-DWL	230922	20	78	27.5	28	19.0	5
K1/2-21-DWL	230923	21	78	28.0	28	24.0	5
K1/2-22-DWL	230924	22	78	29.5	30	24.0	5
K1/2-23-DWL	230925	23	78	30.5	31	24.0	5
K1/2-24-DWL	230926	24	78	32.0	32	24.0	5
K1/2-25-DWL	230927	25	78	33.0	33	24.0	
K1/2-26-DWL	230928	26	78	35.0	35	24.0	
K1/2-27-DWL	230929	27	78	36.0	36	24.0	
K1/2-28-DWL	230930	28	78	37.5	37.5	24.0	
K1/2-30-DWL	230932	30	78	40.0	38	54.0	
K1/2-31-DWL	230933	31	78	41.0	38	54.0	
K1/2-32-DWL	230934	32	78	42.0	38	54.0	



8-point – normal

Model	Item No.	A/F mm	L mm	D1 mm	D2 mm	L2 mm	Pk
K1/2-10-DVK	230870	10	38	20.0	22	7.0	5
K1/2-14-DVK	230874	14	38	26.0	26	11.0	5
K1/2-17-DVK	230877	17	38	30.0	30	11.0	5
K1/2-19-DVK	230879	19	40	34.0	34	13.0	5
K1/2-22-DVK	230882	22	40	38.0	38	15.0	5
K1/2-24-DVK	230884	24	45	42.0	38	18.0	5
K1/2-27-DVK	230887	27	50	46.5	46.5	19.0	5
K1/2-28-DVK	230888	28	50	49.0	49	19.0	5



For more
info, visit our
website.

24/7

* excluded from the manufacturer's warranty.

Mail: info@zemo-tools.de • Phone: +49 (0)40 303 989 100 • Web: www.zemo-tools.de

ZEMO
www.zemo-tools.de

1/2 Power Sockets with 1/2" square drive according to DIN 3121 G 12.5



6-point Surface Drive – normal

Model	Item No.	A/F mm	L mm	D1 mm	D2 mm	L2 mm	Pk
K1/2-10-SD	230511	10	38	17.5	25	12.0	5
K1/2-11-SD	230512	11	38	18.7	25	12.0	5
K1/2-12-SD	230513	12	38	20.0	25	12.0	5
K1/2-13-SD	230514	13	38	21.0	25	12.0	5
K1/2-14-SD	230515	14	38	22.5	25	12.0	5
K1/2-15-SD	230516	15	38	23.7	30	12.0	5
K1/2-16-SD	230517	16	38	25.0	30	12.0	5
K1/2-17-SD	230518	17	38	26.0	30	13.0	5
K1/2-18-SD	230519	18	38	27.5	30	13.0	5
K1/2-19-SD	230520	19	38	28.7	30	13.0	5
K1/2-20-SD	230521	20	38	30.0	30	13.0	5
K1/2-21-SD	230522	21	38	30.0	30	13.0	5
K1/2-22-SD	230523	22	38	32.0	30	13.0	5
K1/2-23-SD	230524	23	38	32.0	30	13.0	5
K1/2-24-SD	230525	24	45	35.0	30	20.0	5
K1/2-26-SD	230526	26	50	38.0	30	22.0	5
K1/2-27-SD	230527	27	50	38.7	30	22.0	5
K1/2-29-SD	230528	29	50	40.0	30	22.0	5
K1/2-30-SD	230529	30	50	42.0	30	22.0	5
K1/2-32-SD	230530	32	50	44.0	30	28.0	5



6-point Surface Drive – deep

Model	Item No.	A/F mm	L mm	D1 mm	D2 mm	L2 mm	Pk
K1/2-10-SDL	230550	10	83	17.5	25	14.0	5
K1/2-11-SDL	230551	11	83	18.7	25	14.0	5
K1/2-12-SDL	230552	12	83	20.0	25	14.0	5
K1/2-13-SDL	230553	13	83	21.0	25	14.0	5
K1/2-14-SDL	230554	14	83	22.5	25	17.0	5
K1/2-15-SDL	230555	15	83	23.7	30	17.0	5
K1/2-16-SDL	230556	16	83	25.0	30	17.0	5
K1/2-17-SDL	230557	17	83	26.0	30	17.0	5
K1/2-18-SDL	230558	18	83	27.5	30	17.0	5
K1/2-19-SDL	230559	19	83	28.7	30	19.0	5
K1/2-20-SDL	230560	20	83	30.0	30	19.0	5
K1/2-21-SDL	230561	21	83	30.0	30	24.0	5
K1/2-22-SDL	230562	22	90	32.0	30	24.0	5
K1/2-23-SDL	230563	23	90	32.0	30	24.0	5
K1/2-24-SDL	230564	24	90	35.0	30	24.0	5
K1/2-26-SDL	230565	26	90	38.0	30	24.0	5
K1/2-27-SDL	230566	27	90	38.7	30	24.0	5
K1/2-29-SDL	230567	29	90	40.0	30	24.0	5
K1/2-30-SDL	230568	30	90	42.0	30	24.0	5
K1/2-32-SDL	230569	32	90	44.0	30	24.0	5

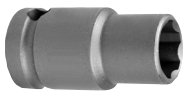

6-point Surface Drive – thin-walled* – normal

Model	Item No.	A/F mm	L mm	D1 mm	D2 mm	L2 mm	Pk
K1/2-10-DWSD	230950	10	38	15.5	22	12.0	5
K1/2-11-DWSD	230951	11	38	16.7	22	12.0	5
K1/2-13-DWSD	230952	13	38	19.2	22	12.0	5
K1/2-14-DWSD	230960	14	38	21.0	24	12.0	5
K1/2-15-DWSD	230953	15	38	21.7	24	12.0	5
K1/2-16-DWSD	230954	16	38	23.0	24	12.0	5
K1/2-17-DWSD	230955	17	38	24.0	24	13.0	5
K1/2-18-DWSD	230956	18	38	25.0	25	13.0	5
K1/2-19-DWSD	230957	19	38	26.0	26	13.0	5
K1/2-21-DWSD	230958	21	38	29.5	28	13.0	5
K1/2-22-DWSD	230959	22	38	30.9	29.5	13.0	5

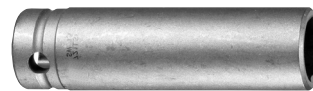

6-point Surface Drive – thin-walled* – deep

Model	Item No.	A/F mm	L mm	D1 mm	D2 mm	L2 mm	Pk
K1/2-10-DWSDL	231010	10	83	15.5	22	14.0	5
K1/2-12-DWSDL	231012	12	83	18.0	22	14.0	5
K1/2-13-DWSDL	231013	13	83	19.2	24	14.0	5
K1/2-14-DWSDL	231014	14	83	21.0	24	17.0	5
K1/2-15-DWSDL	231015	15	83	21.7	24	17.0	5
K1/2-16-DWSDL	231016	16	83	23.0	24	17.0	5
K1/2-17-DWSDL	231017	17	83	24.0	24	17.0	5
K1/2-18-DWSDL	231018	18	83	25.0	25	17.0	5

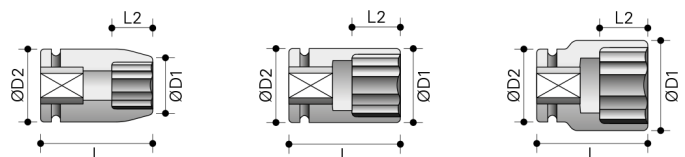

* excluded from the manufacturer's warranty.

For more info, visit our website.





 12-point – normal

Model	Item No.	A/F mm	L mm	D1 mm	D2 mm	L2 mm	Pk
K1/2-6-DSK	231048	6	38	13,0	25	5,0	5
K1/2-8-DSK	231050	8	38	14,0	25	6,0	5
K1/2-9-DSK	231051	9	38	16,0	25	6,0	5
K1/2-10-DSK	231052	10	38	17,5	25	7,0	5
K1/2-11-DSK	231053	11	38	19,0	25	8,0	5
K1/2-12-DSK	231054	12	38	20,0	25	9,0	5
K1/2-13-DSK	231055	13	38	21,0	25	9,0	5
K1/2-14-DSK	231056	14	38	22,5	25	11,0	5
K1/2-15-DSK	231057	15	38	23,5	30	11,0	5
K1/2-16-DSK	231058	16	38	25,0	30	11,0	5
K1/2-17-DSK	231059	17	40	26,5	30	11,0	5
K1/2-18-DSK	231060	18	40	27,5	30	13,0	5
K1/2-19-DSK	231061	19	40	29,0	30	13,0	5
K1/2-20-DSK	231062	20	40	30,0	30	13,0	5
K1/2-21-DSK	231063	21	40	31,0	30	15,0	5
K1/2-22-DSK	231064	22	40	32,5	30	15,0	5
K1/2-23-DSK	231065	23	40	34,0	30	15,0	5
K1/2-24-DSK	231066	24	45	35,0	30	18,0	5
K1/2-25-DSK	231067	25	45	36,0	30	18,0	5
K1/2-26-DSK	231068	26	50	38,0	30	18,0	5
K1/2-27-DSK	231069	27	50	39,0	30	19,0	5
K1/2-28-DSK	231070	28	50	40,0	30	19,0	5
K1/2-29-DSK	231071	29	50	41,0	30	19,0	5
K1/2-30-DSK	231072	30	50	42,5	30	21,0	5
K1/2-32-DSK	231073	32	50	44,0	30	22,0	5
K1/2-33-DSK	231074	33	50	46,5	30	22,0	5
K1/2-36-DSK	231075	36	50	50,5	30	24,0	5
K1/2-41-DSK	231077	41	60	58,5	44	27,0	
K1/2-46-DSK	231079	46	70	65,0	44	30,0	

 12-point – deep

Model	Item No.	A/F mm	L mm	D1 mm	D2 mm	L2 mm	Pk
K1/2-6-DSKL	231150	6	83	13,0	25	5,0	5
K1/2-7-DSKL	231151	7	83	14,0	25	5,0	5
K1/2-8-DSKL	231152	8	83	15,0	25	6,0	5
K1/2-9-DSKL	231153	9	83	16,0	25	6,0	5
K1/2-10-DSKL	231154	10	83	17,5	25	7,0	5
K1/2-11-DSKL	231155	11	83	19,0	25	8,0	5
K1/2-12-DSKL	231156	12	83	20,0	25	9,0	5
K1/2-13-DSKL	231157	13	83	21,0	25	9,0	5

 12-point – deep

Model	Item No.	A/F mm	L mm	D1 mm	D2 mm	L2 mm	Pk
K1/2-14-DSKL	231158	14	83	22,5	25	11,0	5
K1/2-15-DSKL	231159	15	83	23,5	30	11,0	5
K1/2-16-DSKL	231160	16	83	25,0	30	11,0	5
K1/2-17-DSKL	231161	17	83	26,5	30	11,0	5
K1/2-18-DSKL	231162	18	83	27,5	30	13,0	5
K1/2-19-DSKL	231163	19	83	29,0	30	13,0	5
K1/2-20-DSKL	231164	20	83	30,0	30	13,0	5
K1/2-21-DSKL	231165	21	83	31,0	30	15,0	5
K1/2-22-DSKL	231166	22	90	32,5	30	15,0	5
K1/2-23-DSKL	231167	23	90	34,0	30	15,0	5
K1/2-24-DSKL	231168	24	90	35,0	30	18,0	5
K1/2-25-DSKL	231169	25	90	36,0	30	18,0	5
K1/2-26-DSKL	231170	26	90	38,0	30	18,0	5
K1/2-27-DSKL	231171	27	90	39,0	30	19,0	5
K1/2-28-DSKL	231172	28	90	40,0	30	19,0	5
K1/2-29-DSKL	231173	29	90	41,0	30	19,0	5
K1/2-30-DSKL	231174	30	90	42,5	30	21,0	5
K1/2-31-DSKL	231175	31	90	44,0	30	21,0	5
K1/2-32-DSKL	231176	32	90	45,0	30	22,0	5
K1/2-33-DSKL	231177	33	90	46,5	30	22,0	5
K1/2-34-DSKL	231178	34	90	48,0	30	22,0	5
K1/2-35-DSKL	231179	35	90	49,5	30	22,0	5
K1/2-36-DSKL	231180	36	90	50,5	30	24,0	5
K1/2-38-DSKL	231181	38	90	53,0	38	24,0	5
K1/2-39-DSKL	231185	39	93	54,5	44	24,0	5
K1/2-40-DSKL	231186	40	93	56,0	44	58,0	5
K1/2-41-DSKL	231182	41	93	58,0	44	58,0	
K1/2-42-DSKL	231183	42	93	60,0	44	58,0	
K1/2-43-DSKL	231187	43	93	61,0	44	58,0	
K1/2-44-DSKL	231188	44	93	63,0	44	58,0	
K1/2-45-DSKL	231189	45	93	64,0	44	58,0	
K1/2-46-DSKL	231184	46	93	65,0	44	58,0	
K1/2-47-DSKL	231190	47	93	66,5	44	58,0	
K1/2-48-DSKL	231191	48	93	68,0	44	58,0	
K1/2-49-DSKL	231192	49	93	69,0	44	58,0	
K1/2-50-DSKL	231193	50	93	70,0	52	58,0	
K1/2-52-DSKL	231195	52	93	72,5	52	58,0	
K1/2-54-DSKL	231196	54	93	75,0	52	58,0	
K1/2-56-DSKL	231197	56	93	77,0	52	58,0	
K1/2-57-DSKL	231198	57	93	78,0	52	58,0	
K1/2-58-DSKL	231199	58	93	79,0	52	58,0	

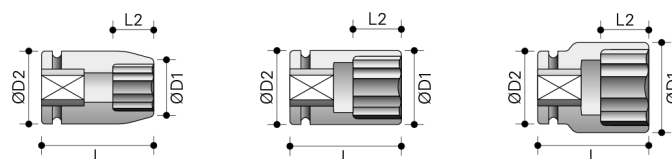

For more
info, visit our
website.

24/7

Mail: info@zemo-tools.de • Phone: +49 (0)40 303 989 100 • Web: www.zemo-tools.de

ZEMO
www.zemo-tools.de

1/2 Power Sockets with 1/2" square drive according to DIN 3121 G 12.5



Torx® E – normal

Model	Item No.	A/F #	L mm	D1 mm	D2 mm	L2 mm	Pk
K1/2-E10	231450	E10	38	15.0	25	7.5	5
K1/2-E11	231451	E11	38	15.5	25	8.0	5
K1/2-E12	231452	E12	38	16.0	25	8.5	5
K1/2-E14	231453	E14	38	18.5	25	10.0	5
K1/2-E16	231454	E16	38	20.0	25	11.0	5
K1/2-E18	231455	E18	38	22.0	25	12.0	5
K1/2-E20	231456	E20	38	25.0	30	13.5	5
K1/2-E22	231457	E22	45	26.5	30	18.0	5
K1/2-E24	231458	E24	45	28.5	30	18.0	5



Torx® E – thin-walled*

Model	Item No.	A/F #	L mm	D1 mm	D2 mm	L2 mm	Pk
K1/2-E10-DW	231650	E10	38	13.0	25	7.5	5
K1/2-E11-DW	231651	E11	38	14.0	25	8.0	5
K1/2-E12-DW	231652	E12	38	15.0	25	8.5	5
K1/2-E14-DW	231653	E14	38	17.0	25	10.0	5
K1/2-E16-DW	231654	E16	38	18.5	25	11.0	5
K1/2-E18-DW	231655	E18	38	20.5	25	12.0	5
K1/2-E20-DW	231656	E20	38	22.5	30	13.5	5
K1/2-E22-DW	231657	E22	45	24.5	30	18.0	5
K1/2-E24-DW	231658	E24	45	26.5	30	18.0	5



Torx® E – deep

Model	Item No.	A/F #	L mm	D1 mm	D2 mm	L2 mm	Pk
K1/2-E10-L	231550	E10	80	14.0	25	7.0	5
K1/2-E12-L	231551	E12	80	15.0	25	8.0	5
K1/2-E14-L	231552	E14	80	18.0	25	9.0	5
K1/2-E16-L	231553	E16	80	19.0	25	10.0	5
K1/2-E18-L	231554	E18	80	22.0	30	11.0	5
K1/2-E20-L	231555	E20	80	24.0	30	13.0	5

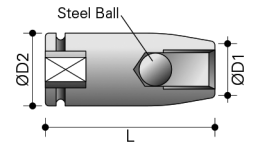

Stud bolt setters

Model	Item No.	Pitch	D1 mm	D2 mm	L mm	Pk
SB1/2-M6-1.0	241210	M6 × 1.0	13	25	55	
SB1/2-M8-1.0	241217	M8 × 1.0	15	25	55	
SB1/2-M8-1.25	241218	M8 × 1.25	15	25	55	
SB1/2-M10-1.0	241220	M10 × 1.0	18	25	55	
SB1/2-M10-1.25	241221	M10 × 1.25	18	25	55	
SB1/2-M10-1.5	241222	M10 × 1.5	17	25	55	
SB1/2-M12-1.25	241225	M12 × 1.25	19	25	55	
SB1/2-M12-1.5	241226	M12 × 1.5	19	25	55	
SB1/2-M12-1.75	241227	M12 × 1.75	19	25	55	
SB1/2-M14-1.5	241230	M14 × 1.5	23	25	55	
SB1/2-M14-2.0	241231	M14 × 2.0	22	25	55	
SB1/2-M16-1.5	241234	M16 × 1.5	28	30	75	
SB1/2-M16-2.0	241235	M16 × 2.0	27	30	75	
SB1/2-M18-2.5	241236	M15 × 1.5	29.5	30	75	
SB1/2-M18-2.5	241238	M18 × 2.5	29	30	75	
SB1/2-M20-1.5	241240	M20 × 1.5	30	30	75	
SB1/2-M20-2.5	241241	M20 × 2.5	30	30	75	



Torx® E – with joint*

Model	Item No.	A/F #	L mm	D1 mm	D2 mm	T mm	Pk
KG1/2-E10	231610	E10	65	13.0	28	7.5	5
KG1/2-E11	231611	E11	65	14.0	28	8.0	5
KG1/2-E12	231612	E12	65	15.0	28	8.5	5
KG1/2-E14	231613	E14	65	17.0	28	10.0	5
KG1/2-E16	231614	E16	65	18.5	28	11.0	5
KG1/2-E18	231615	E18	65	20.5	28	12.0	5
KG1/2-E20	231616	E20	70	22.5	32	13.5	5
KG1/2-E22	231617	E22	70	24.5	32	15.0	5
KG1/2-E24	231618	E24	70	26.5	32	17.0	5

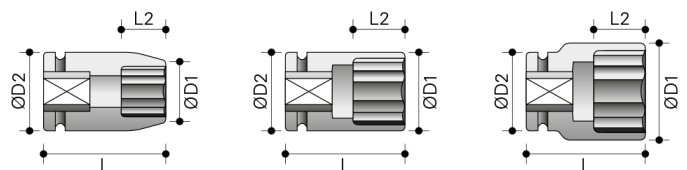

* excluded from the manufacturer's warranty.

For more info, visit our website.

