



6-point w Magnet – normal

Model	Item No.	A/F mm	L mm	D1 mm	D2 mm	L2 mm	Pk
KM3/8-6	220110	6	30	11.5	19	3.0	5
KM3/8-7	220111	7	30	12.5	19	3.0	5
KM3/8-8	220112	8	30	14.0	19	3.0	5
KM3/8-9	220113	9	30	15.0	19	4.0	5
KM3/8-10	220114	10	30	16.5	19	4.0	5
KM3/8-11	220115	11	30	17.5	19	5.0	5
KM3/8-12	220116	12	30	19.0	19	5.0	5
KM3/8-13	220117	13	30	20.0	22	5.0	5
KM3/8-14	220118	14	30	21.5	22	6.0	5
KM3/8-15	220119	15	30	22.0	22	6.0	5
KM3/8-16	220120	16	30	24.0	22	6.0	5
KM3/8-17	220121	17	30	25.0	22	6.0	5
KM3/8-18	220122	18	30	26.0	22	7.0	5
KM3/8-19	220123	19	30	27.5	22	7.0	5

6-point w Magnet – deep

Model	Item No.	A/F mm	L mm	D1 mm	D2 mm	L2 mm	Pk
KM3/8-6-L	220250	6	55	11.5	19	3.0	5
KM3/8-7-L	220251	7	55	12.5	19	3.0	5
KM3/8-8-L	220252	8	55	14.0	19	3.0	5
KM3/8-9-L	220253	9	55	15.0	19	4.0	5
KM3/8-10-L	220254	10	55	16.5	19	4.0	5
KM3/8-11-L	220255	11	55	17.5	19	5.0	5
KM3/8-12-L	220256	12	55	19.0	19	5.0	5
KM3/8-13-L	220257	13	55	20.0	22	5.0	5
KM3/8-14-L	220258	14	55	21.5	22	6.0	5
KM3/8-15-L	220259	15	55	22.0	22	6.0	5
KM3/8-16-L	220260	16	55	24.0	22	6.0	5
KM3/8-17-L	220261	17	55	25.0	22	6.0	5
KM3/8-18-L	220262	18	55	26.0	22	7.0	5
KM3/8-19-L	220263	19	55	27.5	22	7.0	5



6-point w Magnet – inch

Model	Item No.	A/F inch	L mm	D1 mm	D2 mm	L2 mm	Pk
KM3/8-5/16	220150	5/16	34	13.8	19	3.5	5
KM3/8-3/8	220151	3/8	34	16.4	19	3.5	5
KM3/8-1/2	220152	1/2	34	20.2	22	6.0	5

Torx® E with Magnet – normal

Model	Item No.	A/F #	L mm	D1 mm	D2 mm	L2 mm	Pk
KM3/8-E8	220170	E8	32	11.5	19	5.0	5
KM3/8-E10	220171	E10	32	13.5	19	5.0	5
KM3/8-E11	220172	E11	32	14.0	19	5.0	5
KM3/8-E12	220173	E12	32	15.5	19	6.0	5
KM3/8-E14	220174	E14	32	17.5	19	8.0	5
KM3/8-E16	220175	E16	32	19.0	19	9.0	5
KM3/8-E18	220176	E18	32	21.0	20	9.0	5



6-point Surface Drive w Magnet – normal

Model	Item No.	A/F mm	L mm	D1 mm	D2 mm	L2 mm	Pk
KM3/8-10-SD	220550	10	32	16.0	19	4.5	–
KM3/8-13-SD	220552	13	32	20.0	22	6.0	–
KM3/8-16-SD	220554	16	32	24.0	22	7.5	–
KM3/8-17-SD	220555	17	32	25.0	22	7.5	–

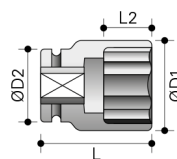
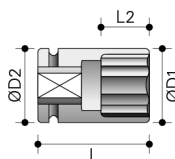
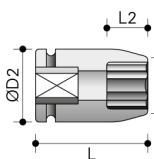

For more
info, visit our
website.

24/7